

HYBRID FIRE

MatriX | 1050/500 I



Specifications

Exterior dimensions WxHxD in mm
1193 x 1023 x 574

Fire display WxHxD in mm
1050 x 500

System
Log Burner 3.0

Decoration
Log set

Back walls
Back wall smooth steel

Remote
Via app and ITC Remote

Power
10,0 kW

Operating system
Honeywell

Energy label
B

Options (at a surcharge)

Inset depth 30 mm
Inset depth 100 mm
HPL Module
Black glass back wal
Non-reflective glass
Adjustable feet
Wall bracket

DECORATION OPTIONS



Heating functionality
Nee

Flue material
130/200

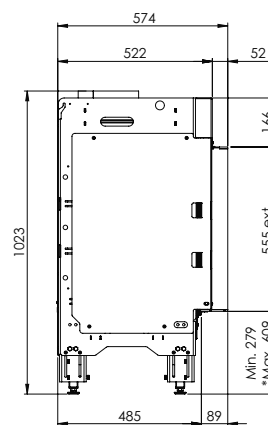
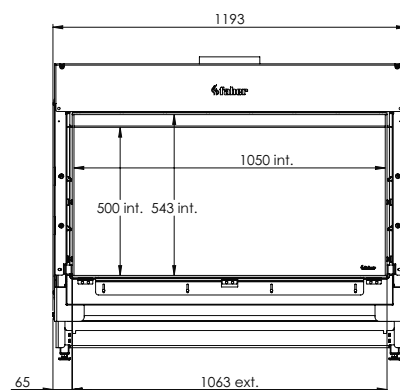
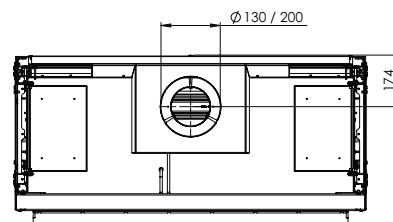

* Incl. optional adjustable feet

There is **so much to tell...**